

T-series Indoor Station User Manual_V1.1

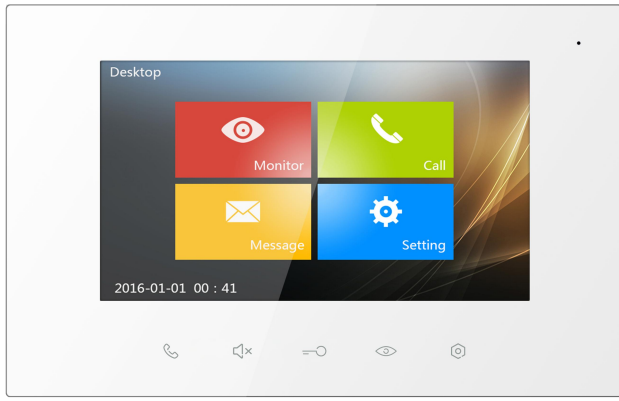

T-IS22

This is user manual for T-IS22

Unit 1 Overview

This Product is an indoor station. Functions such as calling, intercom, monitoring and unlocking are available, details are as below:

- Support video intercom, unlocking
- Support real time monitoring from outdoor station
- Support multiple indoor stations in one house
- Support intercom in one apartment and intercom between different apartments
- Support TF card extension, photo capturing and video recording
- Support secondary doorbell
-

Dimensions & Interface Introduction



Unit: mm

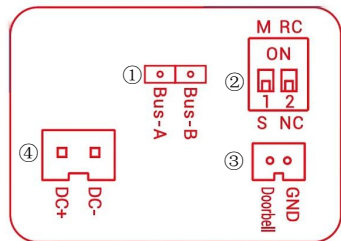
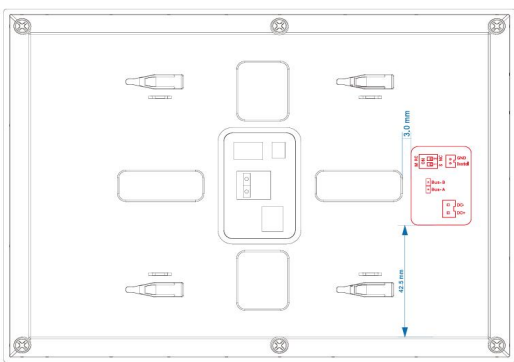

- ①BUS-A : Bus Interface 1;
BUS-B : Bus Interface 2;
- ②1.Master-slave indoor station setting(M stands for Master, S stands for Slave);
2. Video terminal resistance matching.
- ③GND Doorbell: Interface for secondary doorbell button.
- ④Independent power supply interface (DC 21 ~ 32 V);

Note:

- ①Video terminal matching needs to be set on the last indoor station, it means turning the switch No.2 to be ON.
- ②Bus Interface 1 and Bus Interface 2 are for connecting indoor stations by way of hand-in-hand.
- ③Monitor of indoor station will turn on and ring, while slave indoor station will not turn on but only ring.

Key Button Function



- (1) : dial, answer, hang up ;
- (2) : Mute key, Press the key to mute the ringer while ringing
- (3) : Unlock 1&2 icon, Short press to Unlock 1,Long press Unlock 2.
- (4) : Monitor icon
- (5) : Setting icon

Parameter

Working Voltage: DC 24~30V

Static Current: 30V \approx 15 mA

Working Current: 30V \approx 200 mA

Display: 7inch TFT

Resolution: 800x480

TF card capacity: 2~32G(Class 4 is suggested)

Dimensions(L /W /D): 220x140x24 mm

Unit 2 Basic Functions and Setting

Menu

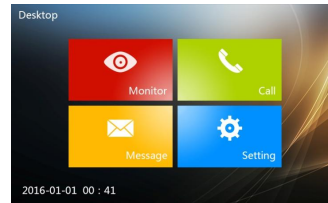

1. Video Monitoring

Click to enter monitoring interface. Image effect setting, photo capturing and video recording can be operated.

2. Intercom

Click to enter intercom interface. User can call and talk in one apartment or different apartments.

3. Message

Click to enter message checking interface, user can check captured photos and recorded videos and device information.

4. Setting

Click to enter setting interface, user can configure ringtone/language/time and operate configuration setting.

Call in

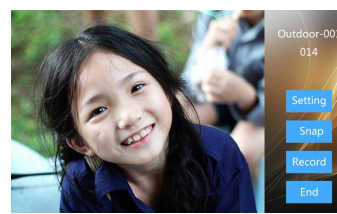

Calling In

Steps: Doorbell rings \Rightarrow Talk \Rightarrow Unlock the door \Rightarrow End of call

Incoming call:

1. Visitor calls the indoor station from outdoor station, the indoor station starts ringing;
2. Resident press button then talk with visitor;
3. During the conversation, resident press button to unlock the door for visitor, 5 seconds later after unlocking the door, the call will be end automatically and system returns to standby mode;
4. Resident press button or click to end the call.

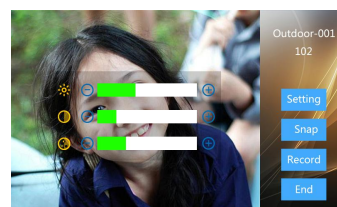

Setting

Setting:

1. When visitor is calling, click to adjust brightness, color and contrast manually.

Photo Capture

1. During the call from visitor, click to capture manually;
2. Captured photos will be saved in message.

Note: Quantity of photo is maximally 50 if there's no extended TF card.

Video Recording:

1. During the call from visitor, click to record a video manually (must insert a TF card);
2. Video will be saved in message.

Note:

With an extended TF card, the quantity of video will be maximally 40, the capacity for photo will be maximally 1000.

Monitoring

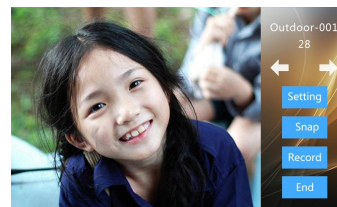

Monitoring

Unlock the door when monitoring

Steps: Choose the device to monitor \Rightarrow Monitoring \Rightarrow Unlock \Rightarrow End

1. Click or press , choose the device to monitor. The default monitoring device is outdoor station 1, if outdoor station 1 doesn't exist, then it can not realize the monitoring.
2. Resident can choose different outdoor station by and . If the chosen monitor doesn't exist, it will exit monitoring and return to standby mode

3. During monitoring, resident can press to unlock for visitor, monitoring will end in 5 seconds after the door is unlocked.
4. Click to end monitoring.

Talk with visitor

Steps: Monitor \Rightarrow Talk \Rightarrow End

1. During monitoring, resident can press to talk with visitor.

Active Call

Click and enter intercom interface.

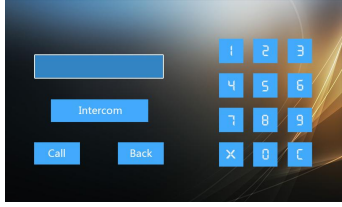

Calling Interface

Intercom between different apartments

Steps: Call⇒Ring⇒Talk⇒End

1. Call
Input the room number and click **Call** to call;
2. Indoor station echoes back;
3. The called resident answers the call, then both sides can talk with each other.
4. Resident press or click **End** to end the call.

Intercom in one apartment

Steps: Call⇒Talk⇒End

1. Click **Intercom** to call the indoor station in one same apartment;
2. The called indoor station in the same apartment echoes back;
3. Resident can press to answer the call. With one more press on button, the call can be ended.

Check Messages

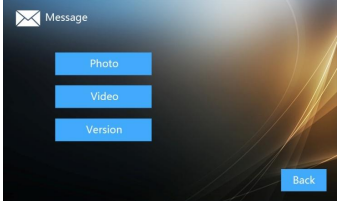

Message Checking

1. Click to check messages, captured photos, recorded videos and device information.

Check Photos



Photo Checking

1. Click **Photo** to check photos.
2. While checking photos, click **Next** to choose the next one, click **Previous** to choose the last one, click **Delete** to delete the current one, Click **Delete All** to empty the photo record.

Video checking



Video Checking

1. Click **Video** to check recorded videos.
2. While checking videos, click **Next** to choose the next one, click **Previous** to choose the last one, click **Delete** to delete the current one,click **Delete All** to empty the video record.

Device Information



Device Information Checking

1. Click **Version** to check device information including software version and device address.

Unit 3 System Setting

Language Setting

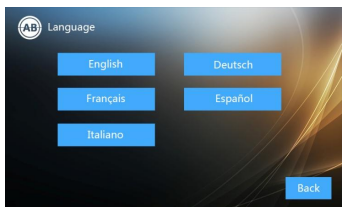

Language Setting Interface

1. Click ⇒ , enter language setting interface.
2. Language must be set in initial start-up.

Configuration Setting

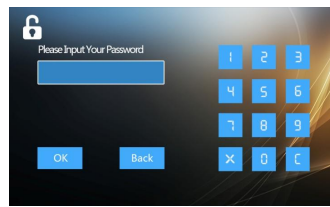

Inputting Password

1. Click ⇒ , input password to enter configuration setting.

Note:
Password is 123456.

ADD Setting

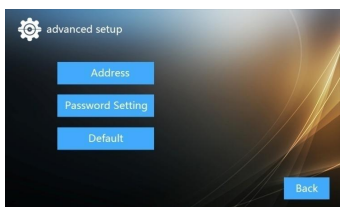

Configuration Setting

1. Click **Address** to enter address setting.

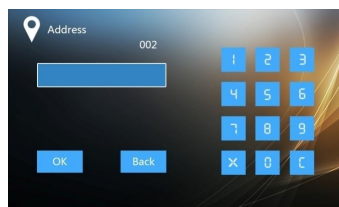

Add Setting

- Note**
- ① Add setting from 001 to 200;
 - ② If there're multiple indoor stations in one apartment, address of all indoor stations should be the same.

Password Setting



Password Setting

1. Click **Password Setting** to enter password setting.
2. Input new password and input again to confirm.

Factory Reset

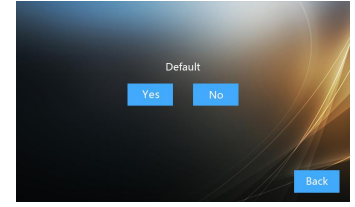

Factory Reset

1. Click **Default** to enter factory reset interface.

Unit 4 Installation Height

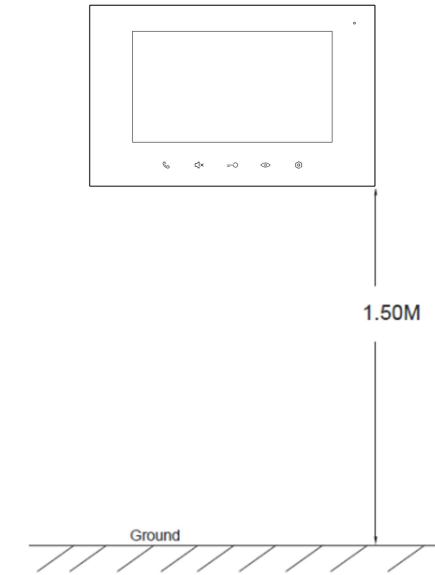

Suggested height for installation: 1.5m

Unit 5 Installation Instruction

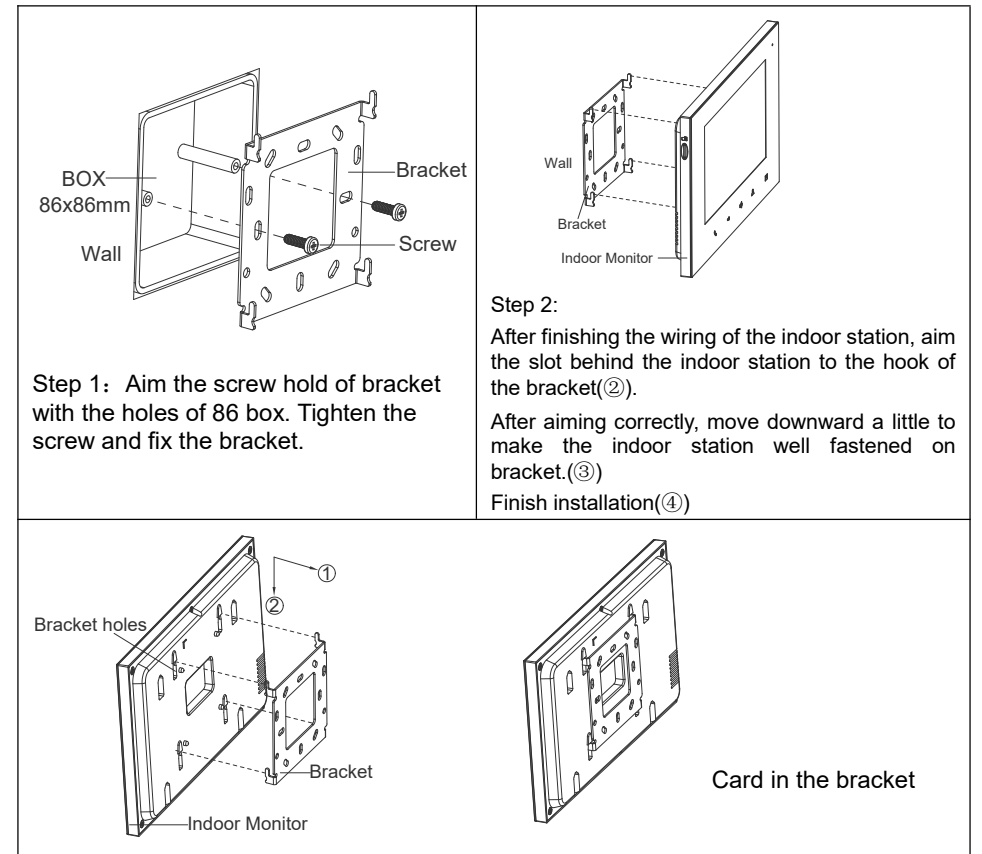

Attentions

1. Please keep devices away from strong magnetic field , high temperature , wet environment ;



2. Please do not fall the devices to the ground or make them get hard impact ;



3. Please do not use wet cloth or volatile reagent to wipe the devices ;



4. Please do not disassemble the devices.